

# SignResource

6135 District Blvd., Maywood, CA 90270  
 Tel: 800-423-4283 FAX: 866-678-9864 www.signresource.com



## Awnings and Fascia Bands Survey Form

### SURVEYED BY

Name \_\_\_\_\_  
 Address \_\_\_\_\_  
 City \_\_\_\_\_ State \_\_\_\_\_ Zip \_\_\_\_\_  
 Phone \_\_\_\_\_ Fax \_\_\_\_\_

### JOB INFORMATION

Customer \_\_\_\_\_  
 Address \_\_\_\_\_  
 City \_\_\_\_\_ State \_\_\_\_\_ Zip \_\_\_\_\_  
 Branch # \_\_\_\_\_

**When ordering awnings and fascia bands please use this form to describe your field measurements and conditions. Please fax this form to our Enterprise Team at 866-678-9864.**

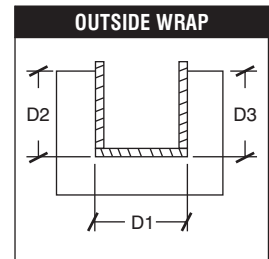
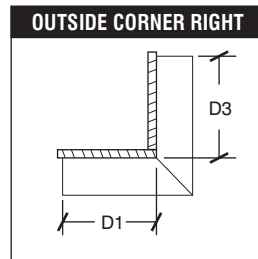
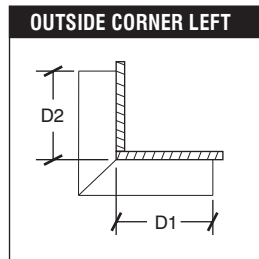
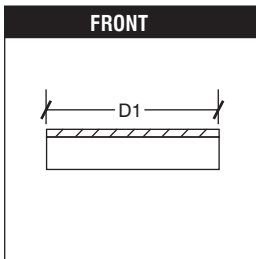

**MEASUREMENTS ARE TO REFLECT BUILDING SIZE NOT FASCIA BAND SIZE**

FASCIA BANDS				
Fascia bands are available in heights from 2' to 6'. Standard depth is 1'.				
SPECIFY DIMENSIONS				
	HEIGHT	DEPTH	LENGTH	ILLUMINATED
D1	_____'	1'	_____ft. _____in.	<input type="checkbox"/> Yes <input type="checkbox"/> No
D2	_____'	1'	_____ft. _____in.	<input type="checkbox"/> Yes <input type="checkbox"/> No
D3	_____'	1'	_____ft. _____in.	<input type="checkbox"/> Yes <input type="checkbox"/> No

AWNINGS				
Standard height and depth is 3' x 3' (Custom sizes available)				
SPECIFY DIMENSIONS				
	HEIGHT	DEPTH	LENGTH	ILLUMINATED
D1	3'	3'	_____ft. _____in.	<input type="checkbox"/> Yes <input type="checkbox"/> No
D2	3'	3'	_____ft. _____in.	<input type="checkbox"/> Yes <input type="checkbox"/> No
D3	3'	3'	_____ft. _____in.	<input type="checkbox"/> Yes <input type="checkbox"/> No

Describe mounting surface material: \_\_\_\_\_

Review site survey and list any obstructions that would impede flush mounting of the fascia band or awning:

SURVEYOR'S SIGNATURE \_\_\_\_\_ DATE: \_\_\_\_\_

PLEASE FAX FORM TO OUR ENTERPRISE TEAM AT 866-678-9864